

Serie M

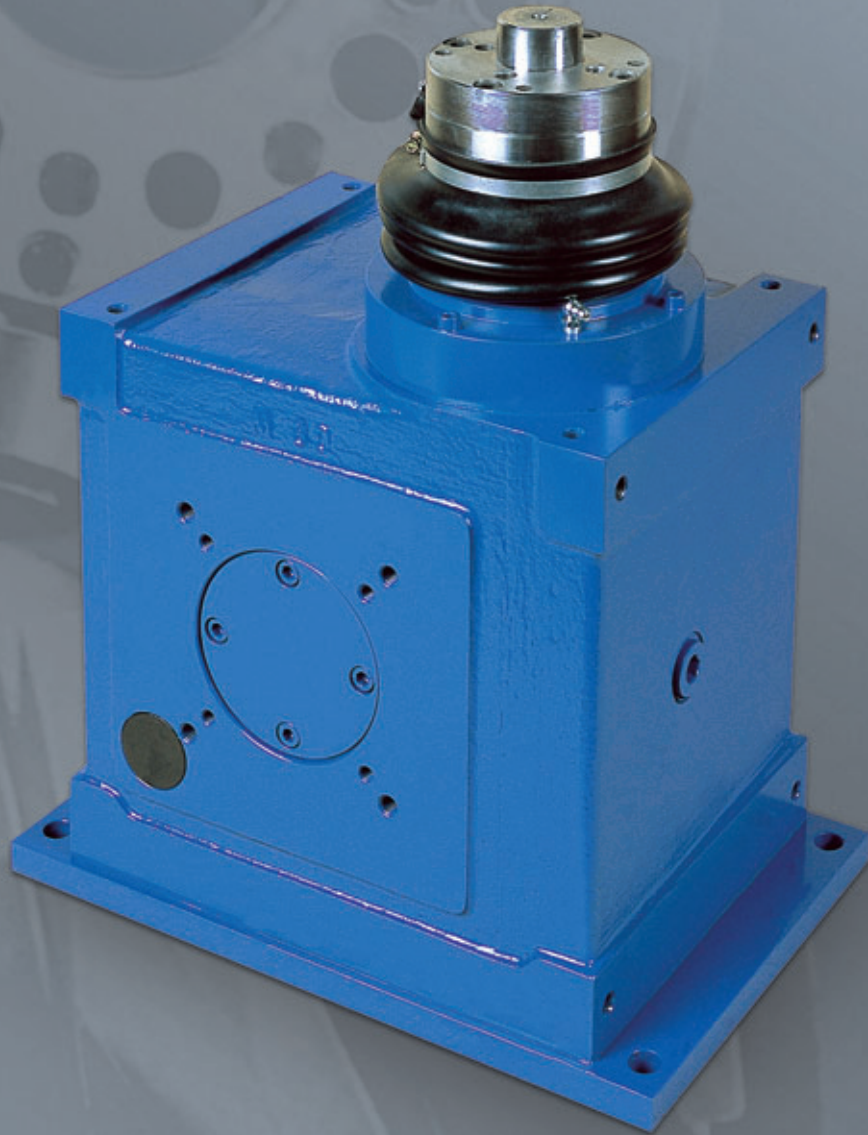

SOPAP



M 63 - 160

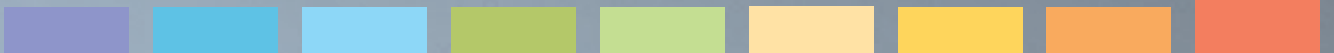

Serie M

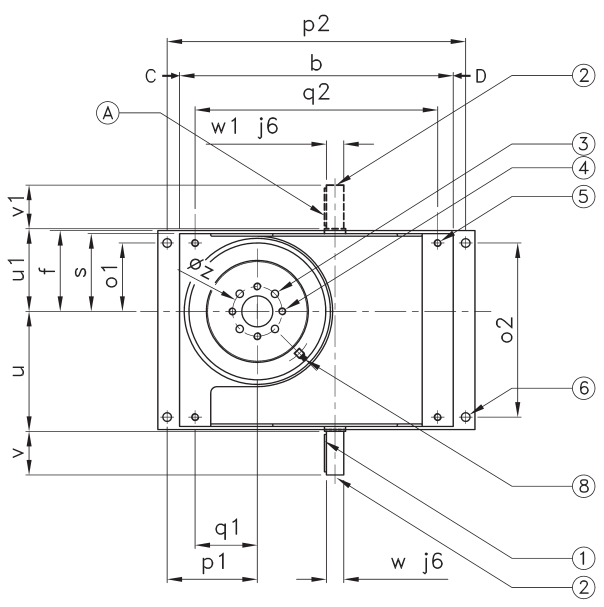
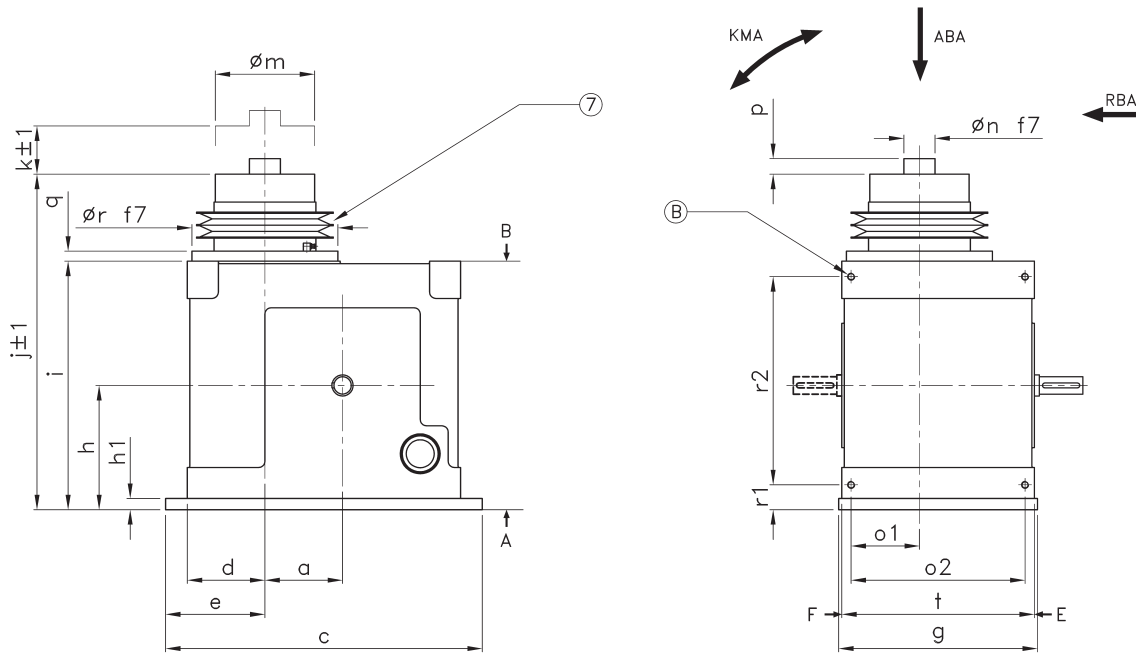

- ① Positioning of the key in the dwell phase (stop period)
- ② Threaded hole **y** for ϕw
Threaded hole **y1** for $\phi w1$
- ③ 4 threaded holes **T**
- ④ Pinning on ϕZ depth max. **t1** to be undertaken by customer
- ⑤ 4 threaded holes **S**
- ⑥ 4 holes $\phi u3$
- ⑦ Protecting bellow
- ⑧ Lubricator

Manipulator MV-MVH

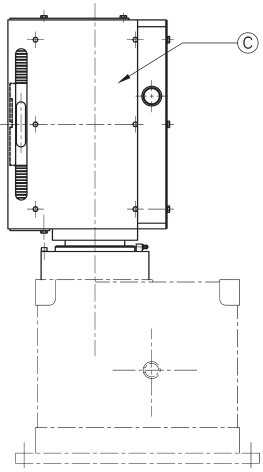

0 to 3	$\pm 0,1$
3 to 6	$\pm 0,1$
6 to 30	$\pm 0,2$
30 to 120	$\pm 0,3$
120 to 400	$\pm 0,5$
400 to 1000	$\pm 0,8$

Manufacturing tolerances of dimensions without tolerances regarding to DIN ISO 2768-1m (mm)

Extra features on request

- (A) Double input shaft
- (B) 4 holes ϕS on face C
- (C) Linear stroke unit with reinforced tilting torque. (see table)

Keys normalised under DIN 6885

3 years warranty on standard products.

Serie M

Dimensions

Size	63	80	100	125	160
a	63	80	100	125	160
b	245	305	360	440	550
c	295	375	430	510	640
d	80	90	105	125	155
e	105	125	140	160	200
f	72,5	95	110	130	160
g	165	235	265	320	395
h	100	170	165	200	235
h1	15	18	18	18	25
i	245	315	325	400	485
j	307	440	475	540	645
Stroke Max. k	40	65	70	85	110
Ø m	90	105	115	160	200
Ø n	25	40	40	50	50
p	12	20	20	25	25
q	12	34	50	16	15
Ø r	155	160	190	235	285
s	70	90	105	125	155
t	160	225	255	310	385
u	93	138	153	188	233
u1	73	93	108	128	158
o1	55	75	90	110	135
o2	130	195	225	280	345
p1	95	110	125	145	180
p2	275	345	400	480	600
q1	70	65	80	100	125
q2	225	255	310	390	490
r1	30	40	40	40	50
r2	185	255	265	335	380
S	M10 x 20	M10 x 20	M10 x 20	M12 x 20	M16 x 30
T	M8 x 15	M10 x 20	M10 x 20	M12 x 20	M12 x 20
t1	15	20	20	20	20
Ø u3	11	12	12	14	18,5
Ø Z	45	60	65	80	100
V	* 40 ** 30	* 40 ** 40 *** 40	* 50 ** 40 *** 40	* 60 ** 50 *** 40	* 60 ** 50 *** 50
y for w std	M5 M4	M5 M5 M5	M6 M5 M5	M8 M6 M5	M10 M6 M6
Ø w Standard	19 14	19 19 19	24 19 19	28 24 19	35 24 24
Ø w Max	24 24	28 28 28	35 35 35	42 42 42	48 48 48
v1	40 30	40 40 40	50 40 40	60 50 40	80 50 50
y1 for w1 std	M5 M4	M5 M5 M5	M6 M5 M5	M8 M6 M5	M10 M6 M6
Ø w1 Standard	19 14	19 19 19	24 19 19	28 24 19	35 24 24
Ø w1 Max	19 14	24 19 19	28 24 24	28 28 24	35 28 28
Weight (kg)	~ 50	~ 80	~ 115	~ 170	~ 320

* until 10 stops

** 12 to 16 stops

*** 20 to 24 stops

Dimensions for reducers and motors, please contact us

Technical characteristics

Size	63	80	100	125	160
Concentricity on diam. n without loading (mm)	0,2	0,2	0,2	0,2	0,2
Flatness on diam. m without loading (mm)	0,1	0,1	0,1	0,1	0,1
Max. allowable axial load ABA (daN)	50	200	250	300	450
Max. allowable radial load RBA (daN)	40	65	88	115	149
Max. allowable tilting torque KMA (daNm)	5	10	15	23	35

Size MV and MVH	MV80	MVH80	MV100	MVH100	MV125	MV160
Max. linear stroke (mm)	130	200	140	200	170	220
Max. allowable tilting torque (daNm)	20	20	40	40	80	100

Dimensions and further characteristics, please contact us

Angle of Rotation:

180° - 120° - 90° - 60° - 45° - 30°

Further angles of rotation on request

Standard cycles

13 standard motion cycles are available for continuous running or single stroke operation. The stopping points have been placed on points 1 and 4 as an example only. Generally, the stopping points can be placed on any point from 1 to 6. For stopping points to be placed somewhere else (i.e. after half stroke) please contact us.

● Starting point

Continuous running and single stroke operation

Single stroke operation with reversal of motor

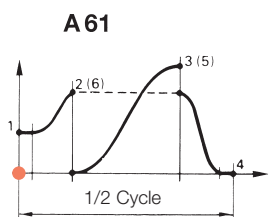
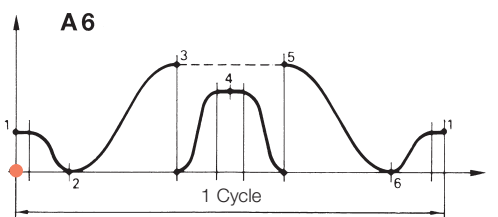
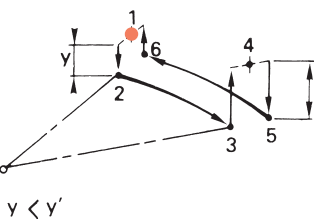
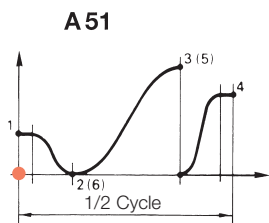
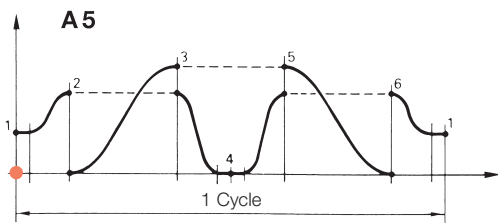
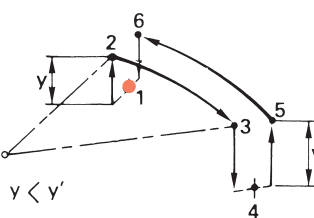
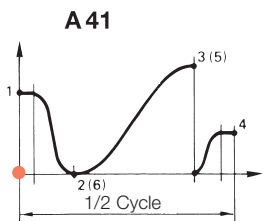
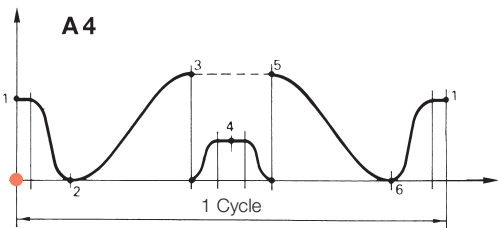
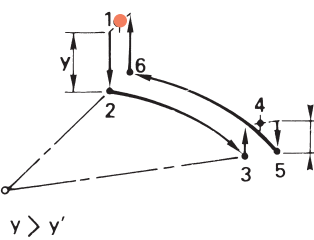
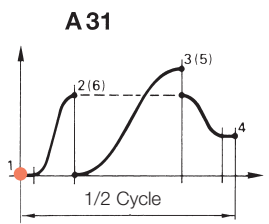
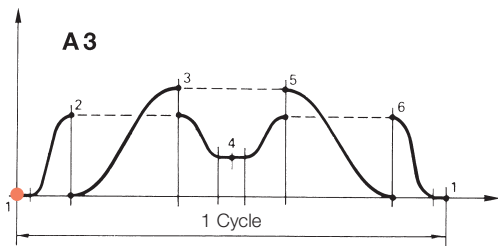
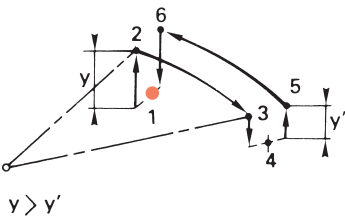
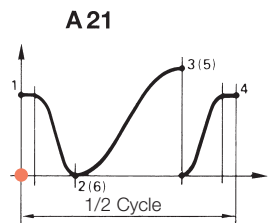
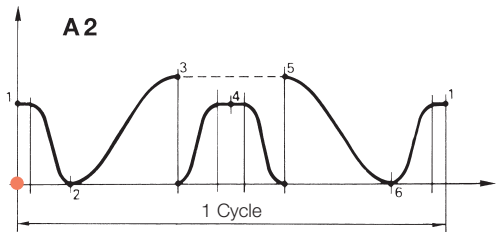
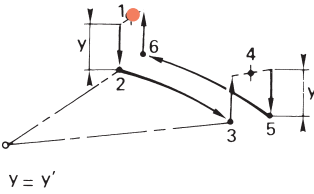
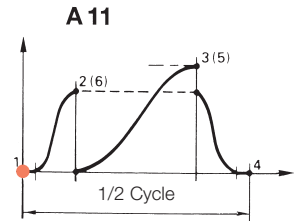
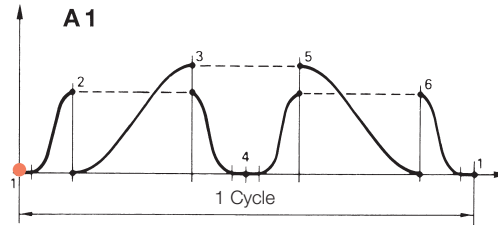
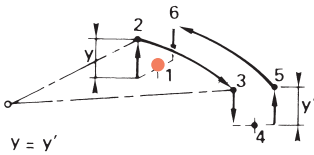

● Starting point

Continuous running and single stroke operation

Single stroke operation with reversal of motor

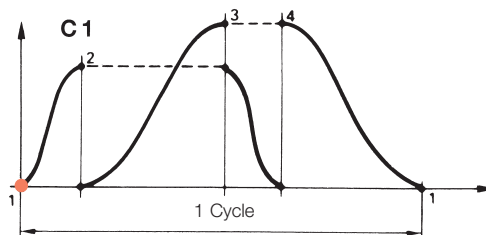
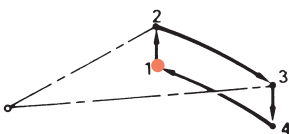
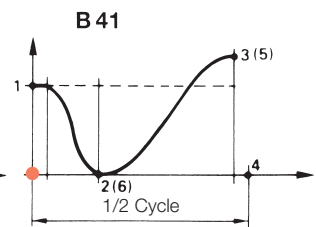
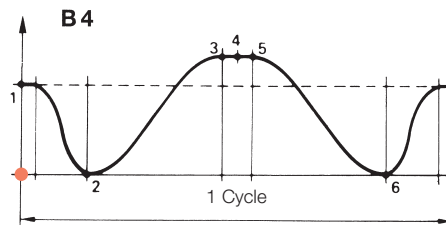
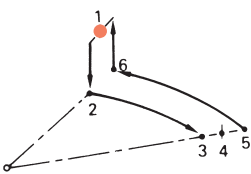
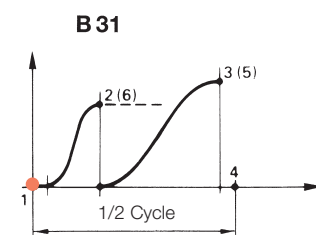
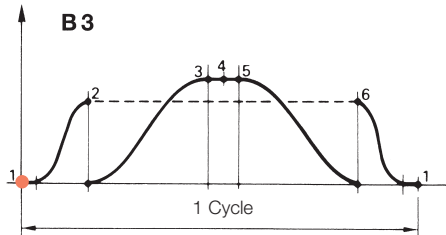
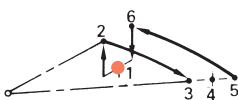
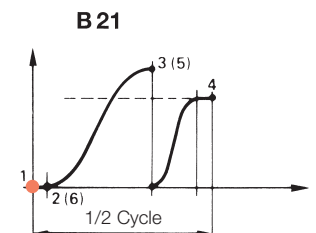
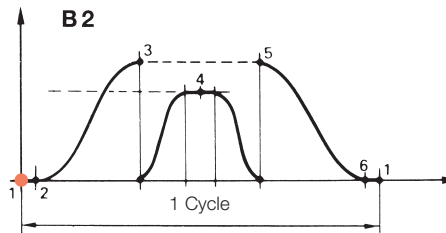
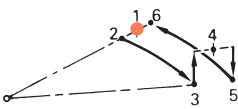
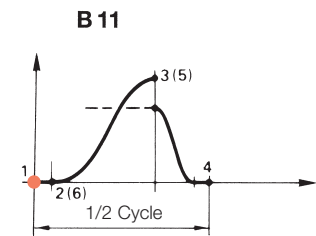
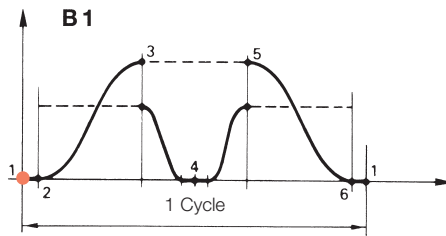
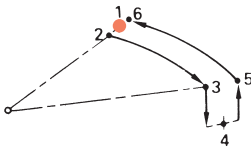
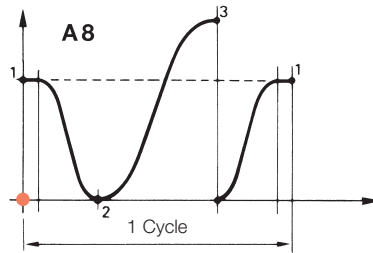
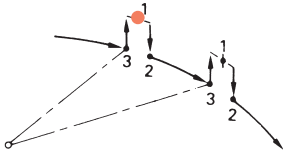
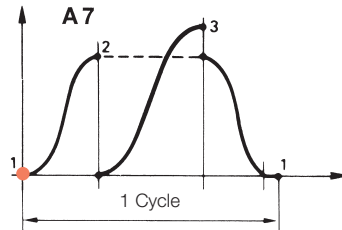
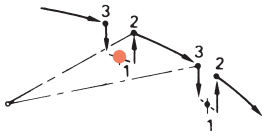



SOPAP



SOPAP ensures quality and reliability

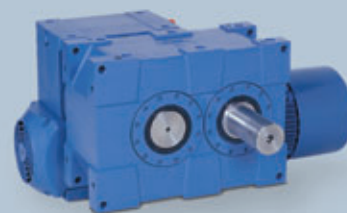

France

SOPAP SAS
Z.A.M Châlons Nord
1 Rue des Vignettes
F-51520 La Veuve

Téléphone: +33 (0) 3 26 69 21 21
Télécopie: +33 (0) 3 26 69 21 31
E.mail: info.fr@sopap.com

Deutschland Süd

SOPAP GmbH
Mittelöschstrasse 21
D-88213 Ravensburg

Telefon: +49 (0) 751 9507
Telefax: +49 (0) 751 92583
E.mail: info-sued.de@sopap.com

España

SOPAP Automatización S.L.
%Las Cruces nº6 – Bajo C
E-28230 Las Rozas
Madrid

Teléfono: +34 91 636 01 39
Teléfax: +34 91 636 02 64
E.mail: info.es@sopap.com

Benelux

ADR
Solvayweg 18
6049 CP Herten-Roermond
Nederland

Telefoon: +31 475 337379
Fax: +31 475 337444
E.mail: info.nl@sopap.com

Brasil

Triaxis
Rua Bulgária, 215
Vila Santa Luzia
09871-100 Sao Bernardo do Campo

Telefone: +55 11 4361 4977
Fax: +55 11 4361 9004
E.mail: info.br@sopap.com

Deutschland Mitte

Konstruktionsbüro Becker
Hch. Von Brentanoweg 2
D-64683 Einhausen

Telefon: +49 (0) 6251 856601
Telefax: +49 (0) 6251 987701
E.mail: info-mitte.de@sopap.com

USA

SOPAP LLC
560-A Brookshire Road
29651 Greer
South Carolina

Telephone: +1 864 801 1450
Fax: +1 864 801 1460
E.mail: info-sc.usa@sopap.com

USA

Rudy V. Colombi
2696 Red Fox Trail
48098 Troy
Michigan

Telephone: +1 248 840 2377
Fax: +1 248 540 7535
E.mail: info-mi.usa@sopap.com

Canada

DOLYX trading inc.
171 Nicholson Crt.
L7N 3N5 Burlington
Ontario

Telephone: +1 905 631 6615
Fax: +1 905 631 6244
E.mail: info-on.ca@sopap.com